

MANCHESTER TOWNSHIP SECTION 21 R 10 TWP 7 MORGAN COUNTY, OHIO

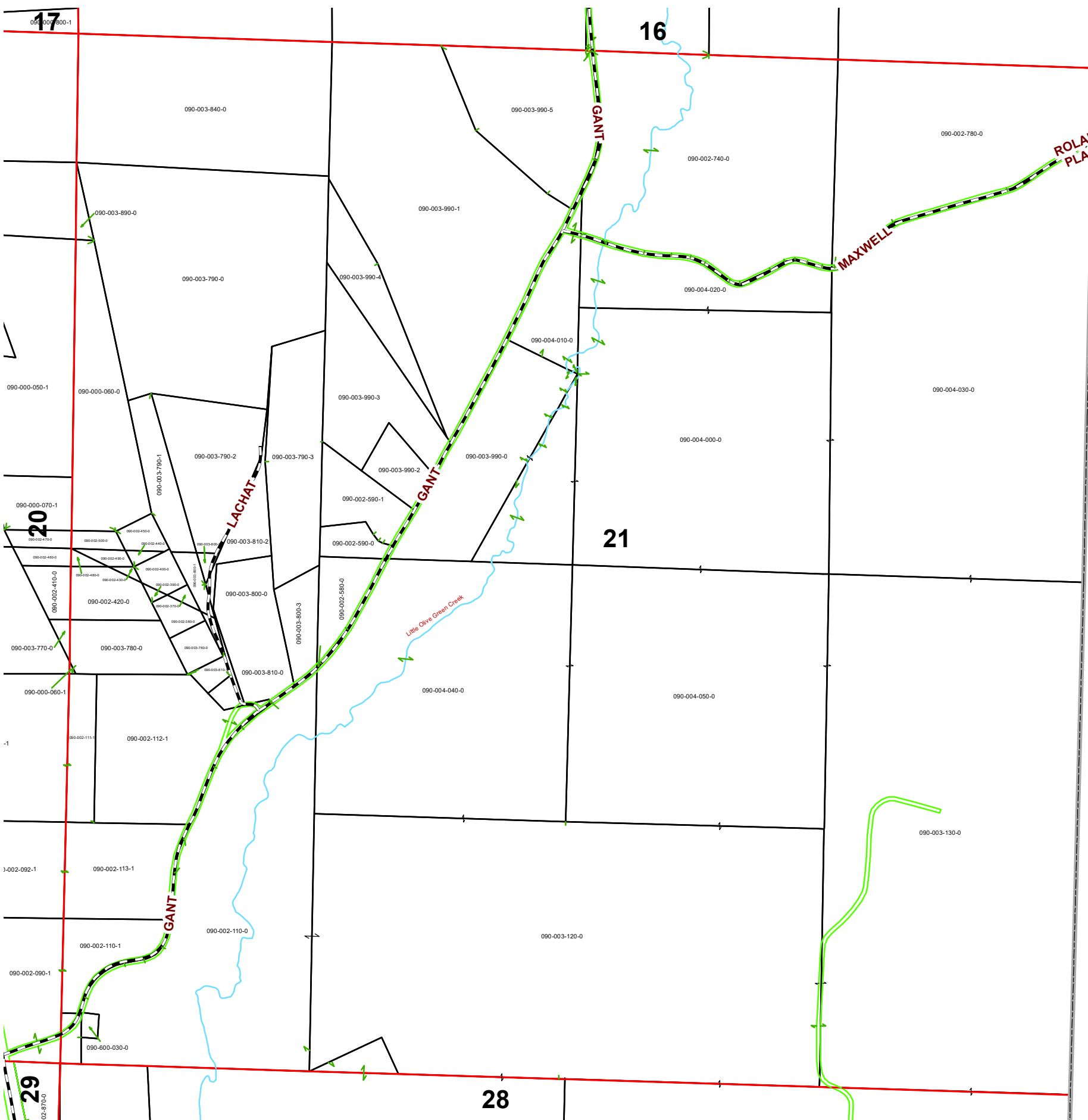

PIN	Owner	LegalDescr	Acres	VOL	PAGE	Survey_Ref
U//I			0	DB Vol. D 213		MAN-0093.pdf
090-600-030-0	CEMETERY (REHOBETH)	R10 T07 S21 0 REHOB	0.26	OR230	996	MAN-0101.pdf
090-003-760-0	FOWLER VAUGHN	R10 T07 S21 SD 25	1	OR45	645	MAN-0003.pdf
090-003-780-0	FOWLER VAUGHN	R10 T07 S21 SD 32 S	3.51	OR45	645	MAN-0003.pdf
090-003-810-1	FOWLER VAUGHN T	R10 T07 S21 SD 43	0.662	OR45	645	MAN-0037.pdf
090-002-380-0	FOWLER VAUGHN T	R10 T07 S21 SD 27	0.22	OR45	629	MAN-0003.pdf
090-002-370-0	FOWLER VAUGHN T	R10 T07 S21 SD 26	0.78	OR45	645	MAN-0003.pdf
090-002-390-0	FOWLER VAUGHN T	R10 T07 S21 SD 30	0.15	OR45	645	MAN-0003.pdf
090-002-430-0	FOWLER VAUGHN T	R10 T07 S21 SD 34	0.25	OR45	645	NoSurvey.pdf
090-002-420-0	FOWLER VAUGHN T	R10 T07 S21 SD 33	3.49	OR45	645	MAN-0003.pdf
090-003-800-1	FOWLER VAUGHN T	R10 T07 S21 SD 44	0.644	OR45	645	MAN-0037.pdf
090-002-440-0	FOWLER VAUGHN T	R10 T07 S20 SD 28	0.1	OR45	645	MAN-0003.pdf
090-002-400-0	FOWLER VAUGHN T	R10 T07 S21 SD 31	0.85	OR45	645	MAN-0003.pdf
090-002-480-0	FOWLER VAUGHN T	R10 T07 S21 SD 35	0.1	OR45	645	MAN-0003.pdf
090-002-490-0	FOWLER VAUGHN T	R10 T07 S21 SD 36	0.34	OR45	645	MAN-0003.pdf
090-002-500-0	FOWLER VAUGHN T	R10 T07 S21 SD 37	0.77	OR45	645	MAN-0003.pdf
090-002-450-0	FOWLER VAUGHN T	R10 T07 S21 SD 29	0.9	OR45	645	MAN-0003.pdf
090-003-790-1	FOWLER VAUGHN T	R10 T07 S21 SD 45	2.898	OR45	645	MAN-0037.pdf
090-000-060-0	FOWLER VAUGHN T	R10 T07 S21 SD 7	9.346	OR45	645	MAN-0016.pdf
090-003-800-3	GAY JAMES E & TERESA L	R10 T07 S21 SD 50 S	2.345	OR232	2537	MAN-0052A.pd
090-002-580-0	GAY JAMES E & TERESA L	R10 T07 S21 SD 24 S	2.52	OR232	5935	MAN-0054.pdf
090-003-990-2	GAY JAMES E & TERESA L	R10 T07 S21 SD 46	2	OR232	5926	MAN-0049.pdf
090-003-990-3	GAY JAMES E & TERESA L	R10 T07 S21 SD 47	8	OR232	5926	MAN-0049.pdf
090-003-990-4	GAY JAMES E & TERESA L	R10 T07 S21 SD 52 S	4.01	OR232	5926	MAN-0069.pdf
090-002-590-0	GAY JAMES E & TERESA L	R10 T07 S21 SD 5 SU	1.296	OR232	5935	MAN-0054.pdf
090-002-590-1	GAY LARRY E & VIRGINA E & JAMES	R10 T7 S21 SD58	3.044	OR232	5935	MAN-0106.pdf
090-003-800-2	LACHAT DIANA A TRUSTEE	R10 T07 S21 SD 49	0.175	OR220	24	MAN-0048.pdf
090-003-790-2	LACHAT DIANA A TRUSTEE	R10 T07 S21 SD 48	7.032	OR220	24	MAN-0048.pdf
090-003-790-3	LACHAT DIANA A TRUSTEE	R10 T07 S21 SD 49	7.959	OR220	24	MAN-0052A.pd
090-003-810-2	LACHAT DIANE A TRUSTEE	R10 T07 S21 SD 51	3.174	OR220	24	MAN-0061.pdf
090-002-740-0	MILLER ADEN & BERT	R10 T07 S21 SD 2	31.619	OR211	3116	MAN-0041.pdf
090-003-890-0	POST ROBERT D & JANICE K	R10 T07 S21 SD 40	0.445	D.V 179	149	MAN-0009.pdf
090-003-840-0	POST ROBERT D & JANICE K	R10 T07 S21 SD 6	21	OR175	629	NoSurvey.pdf
090-003-790-0	POST ROBERT D SR & JANICE K	R10 T07 S21 SD 39 S	29.718	OR182	347	MAN-0008.pdf
090-002-780-0	SCHEURING SCOTT W	R10 T07 S21 SD 38	21.98	OR173	782	MAN-0006.pdf
090-003-990-5	SPASIC SLAVKO & JEFFREY M	R10 T07 S21 SD 53	10.44	OR175	484	MAN-0069.pdf
090-003-990-1	ST CLAIR NICHOLAS	R10 T07 S21 SD 42	32.06	OR235	89	MAN-0028.pdf
090-003-810-0	VINTILA JOHN & DEBBIE	R10 T07 S21 SD 16 S	5.311	OR131	164	MAN-0061.pdf
090-002-113-1	VINTILA JOHN D & DEBBIE	R10 T7 S21 SD 54	6.86	OR231	1718	MAN-0099.pdf
090-002-112-1	VINTILA JOHN D & DEBBIE	R10 T7 S21 SD56	11.38	OR231	1718	MAN-0099.pdf
090-002-111-1	VINTILA JOHN D & DEBBIE	R10 T7 S21 SD55	2.54	OR231	1718	MAN-0099.pdf
090-002-110-1	VINTILA JOHN D & DEBBIE	SD 54	3.69	OR231	1718	MAN-0099.pdf

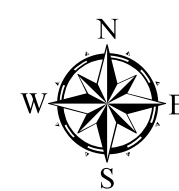

Boundaries

- Hydro (Blue line)
- Roads (Black line)
- County (Dashed black line)
- Lot (Yellow line)
- Parcel (Black line)
- Section (Red line)
- Township (Dotted red line)
- ROW (Green line)



Disclaimer: The information that these maps contains is for reference purposes only. Please bring any erros to the attention of the Engineer's Office staff. Thank you

Source: Morgan County Engineer's Office
 Author: Marcia Wolfe
 Date: 12/31/20

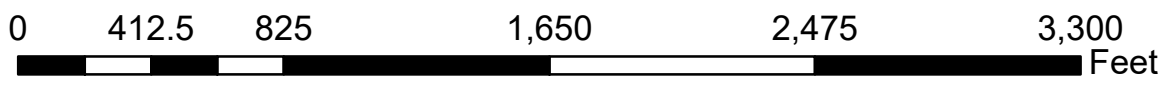

MANCHESTER TOWNSHIP SECTION 21 R 10 TWP 7 MORGAN COUNTY, OHIO

PIN	Owner	LegalDescr	Acres	VOL	PAGE	Survey_Ref
090-004-040-0	WHITETAIL PROPERTY DEVELOPMENT	R10 T07 S21 SD 9	37.48	OR226	2850	NoSurvey.pdf
090-004-010-0	WHITETAIL PROPERTY DEVELOPMENT	R10 T07 S21 SD 14-19	7.4	OR226	2850	NoSurvey.pdf
090-003-990-0	WHITETAIL PROPERTY DEVELOPMENT	R10 T07 S21 SD 4	11.09	OR226	2850	NoSurvey.pdf
090-004-020-0	WHITETAIL PROPERTY DEVELOPMENT	R10 T07 S21 SD 23	5	OR226	2850	NoSurvey.pdf
090-002-110-0	WHITETAIL PROPERTY DEVELOPMENT	R10 T07 S21 SD 8 J B	36.08	OR232	2721	MAN-0090.pdf
090-003-120-0	WHITETAIL PROPERTY DEVELOPMENT	R10 T07 S21 SD 10	80.557	OR233	2864	MAN-0108.pdf
090-003-130-0	WHITETAIL PROPERTY DEVELOPMENT	R10 T07 S21 SD 13	81.971	OR234	4355	MAN-0111.pdf
090-004-050-0	WHITETAIL PROPERTY DEVELOPMENT	R10 T07 S21 SD 11	39	OR226	2850	NoSurvey.pdf
090-004-000-0	WHITETAIL PROPERTY DEVELOPMENT	R10 T07 S21 SD 3	40	OR226	2850	NoSurvey.pdf
090-004-030-0	WHITETAIL PROPERTY DEVELOPMENT	R10 T07 S21 SD 1	57.02	OR226	2850	NoSurvey.pdf

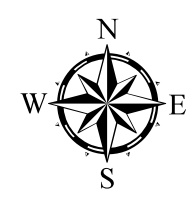
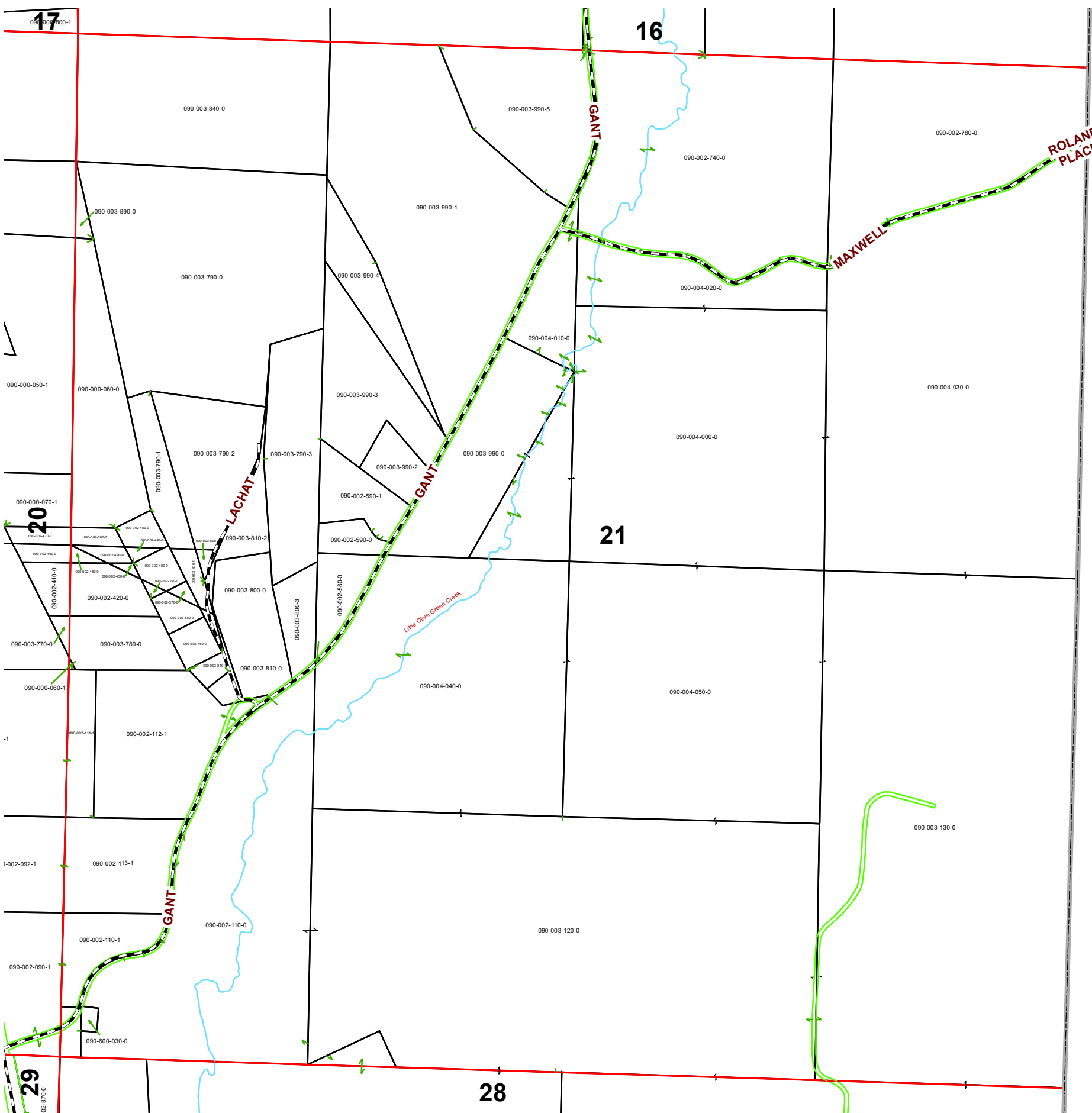

Boundaries			
	Hydro		Section
	Roads		Lot
	County		Township
	Parcel		ROW



Disclaimer: The information that these maps contains is for reference purposes only. Please bring any errors to the attention of the Engineer's Office staff. Thank you

Source: Morgan County Engineer's Office
 Author: Marcia Wolfe
 Date: 12/31/20

